

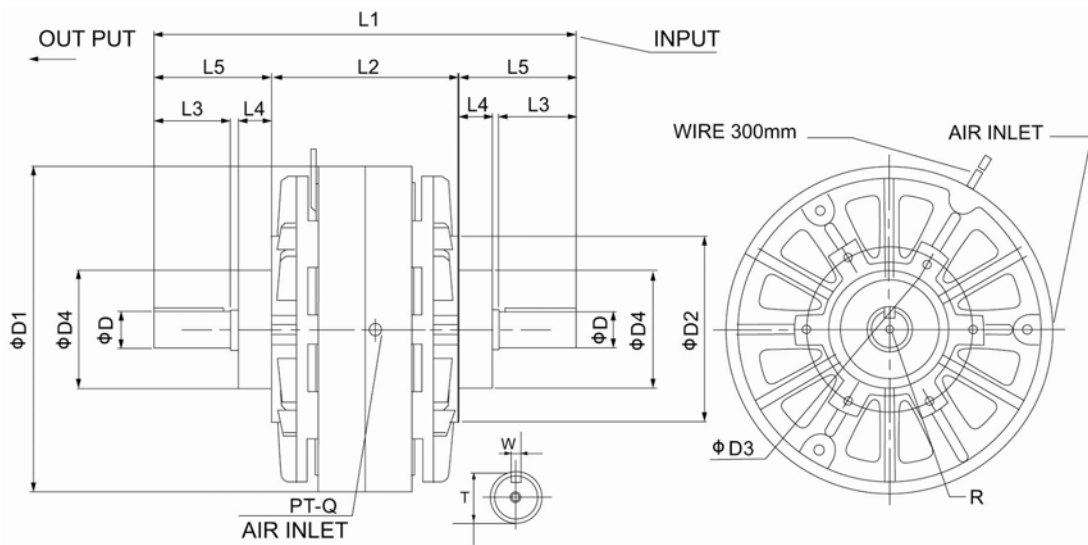

**Specification**

Type	Fix torque kgfm(Nm)	Capability (75°C)			Inertial torque (kgm <sup>2</sup> )		Compelling air-cooling concessional slide rate of work			Weight (kg)	Max. speed of Rotation (r/min)	Weight of Magnetic Powder (g)
		Electric (A)	Electric Power (W)	(S)	INPUT	OUTPUT	Air pressure (pa)	Air volume (m3/min)	Ratio (W)			
POC-006	0.6 (6)	0.81	19.4	0.09	$6.00 \times 10^{-4}$	$1.93 \times 10^{-4}$	$1.8 \times 10^4$	0.1	170	5.2	1800	10
POC-012	1.2(12)	0.94	22.5	0.10	$1.34 \times 10^{-3}$	$4.90 \times 10^{-4}$	$3 \times 10^4$	0.2	250	6	1,800	20
POC-025	2.5(25)	1.24	30	0.12	$3.80 \times 10^{-3}$	$1.49 \times 10^{-3}$	$5 \times 10^4$	0.4	380	11	1,800	33
POC-050	5(50)	2.15	51.5	0.13	$9.50 \times 10^{-3}$	$4.80 \times 10^{-3}$	$1 \times 10^5$	0.6	700	18.5	1,800	60
POC-100	10(100)	2.40	57.6	0.25	$3.50 \times 10^{-2}$	$2.50 \times 10^{-2}$	$6 \times 10^4$	1.1	1,100	37	1,800	140
POC-200	20(200)	2.70	64.8	0.37	$9.15 \times 10^{-2}$	$6.89 \times 10^{-2}$	$5 \times 10^4$	1.6	1,900	59	1,800	225
POC-400	40(400)	5	120	0.40	$2.43 \times 10^{-1}$	$1.50 \times 10^{-1}$	$1.6 \times 10^5$	2.0	2,100	110	1,800	300

Size of appearance (mm)



**Specification**

Type	L1	L2	L3	L4	L5	D1	D2	D3	D4(G7)	Q	R		Axis body		
											Pathway	Depth	D(h7)	W(p7)	T(0-0.2)
POC-006	164	72	26	14	46	134	***	64	42	1/8	M4	10	12	4	13.5
POC-012	192	94	29	15	49	152	126	64	42	1/8	M4	8	15	5	17
POC-025	230	102	43	17	64	184	160	78	55	1/8	M5	10	20	5	22
POC-050	294	112	55	30	91	219	196	100	74	1/4	M6	12	25	7	28
POC-100	360	160	65	28	100	278	160	140	100	3/8	M10	20	30	7	33
POC-200	408	190	69	30	109	327	174	150	110	3/8	M10	20	35	10	38.5
POC-400	500	221	92	35	139	398	230	200	130	3/8	M10	20	45	12	48.5

We reserve the right of changing specification or size to our products